



Autostart configuration with a Bluetooth device on iOS

STEP n°1

Before you start, make sure your phone is connected to the Bluetooth device you want to pair.

In the application menu, click on **My Vehicles**

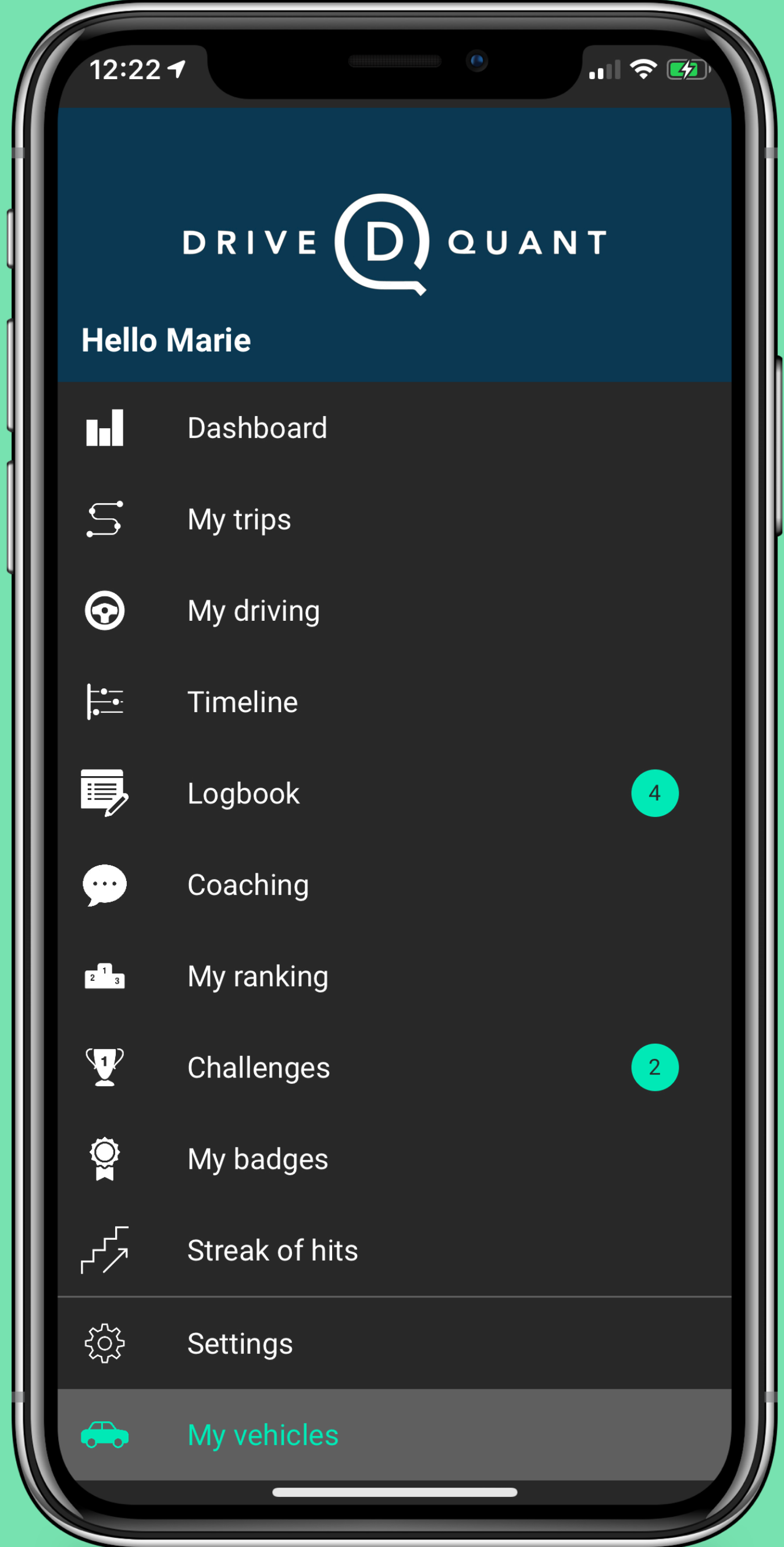

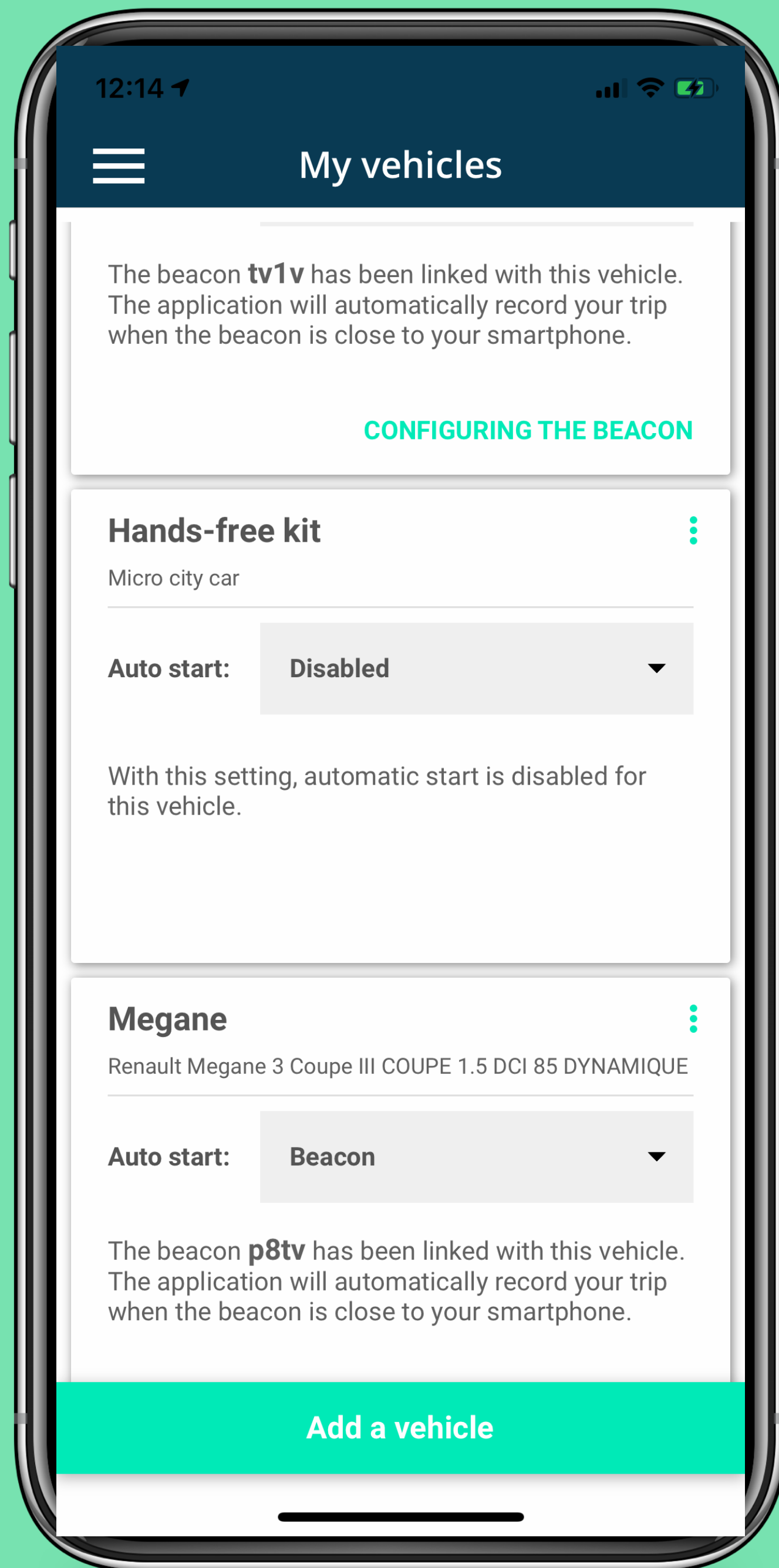

STEP n°2

← Once your vehicle has been created, choose the Auto start mode by clicking on **Disabled**



STEP n°3

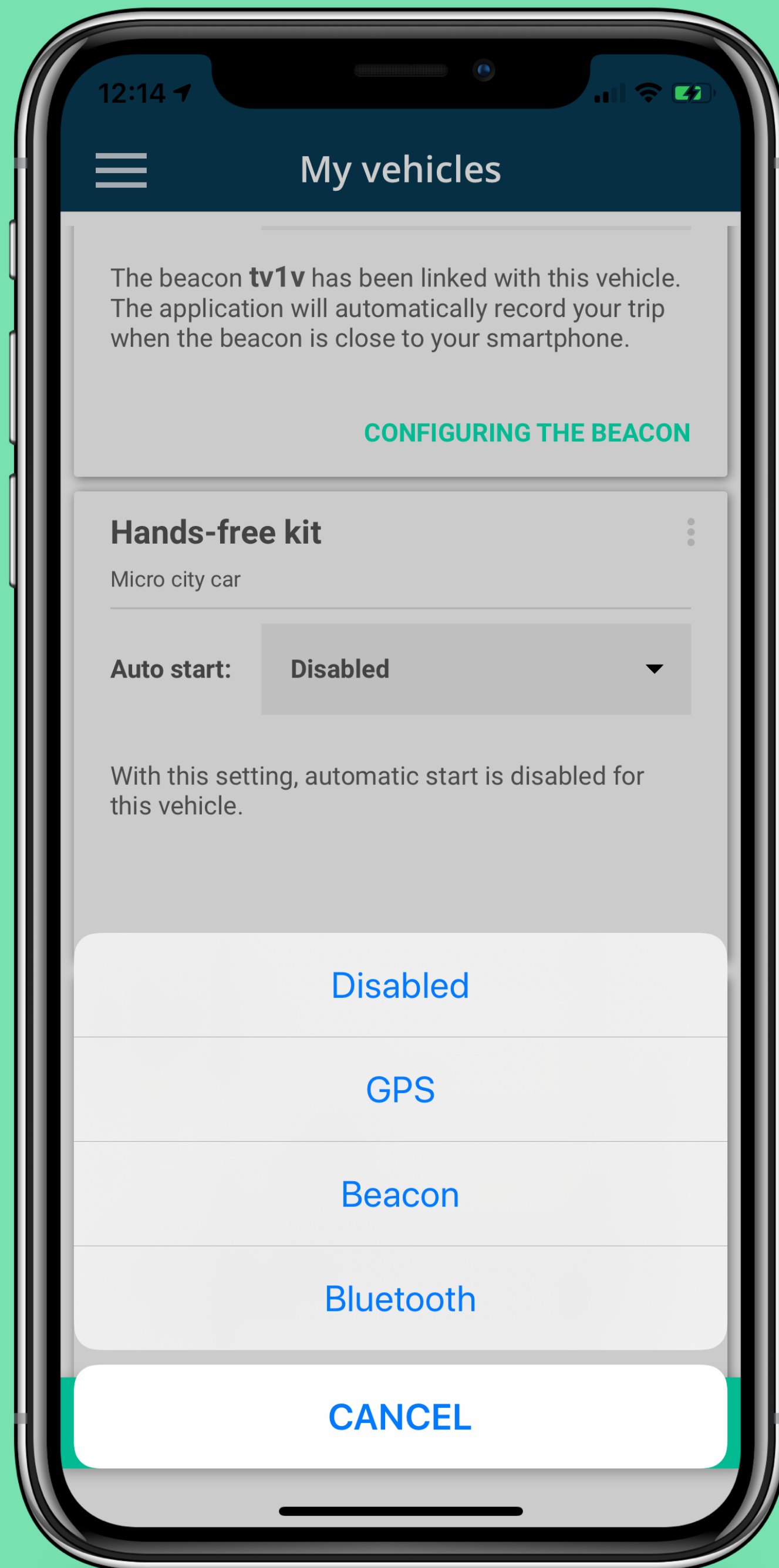

Choose your Auto start mode,
click on **Bluetooth**



STEP n°4

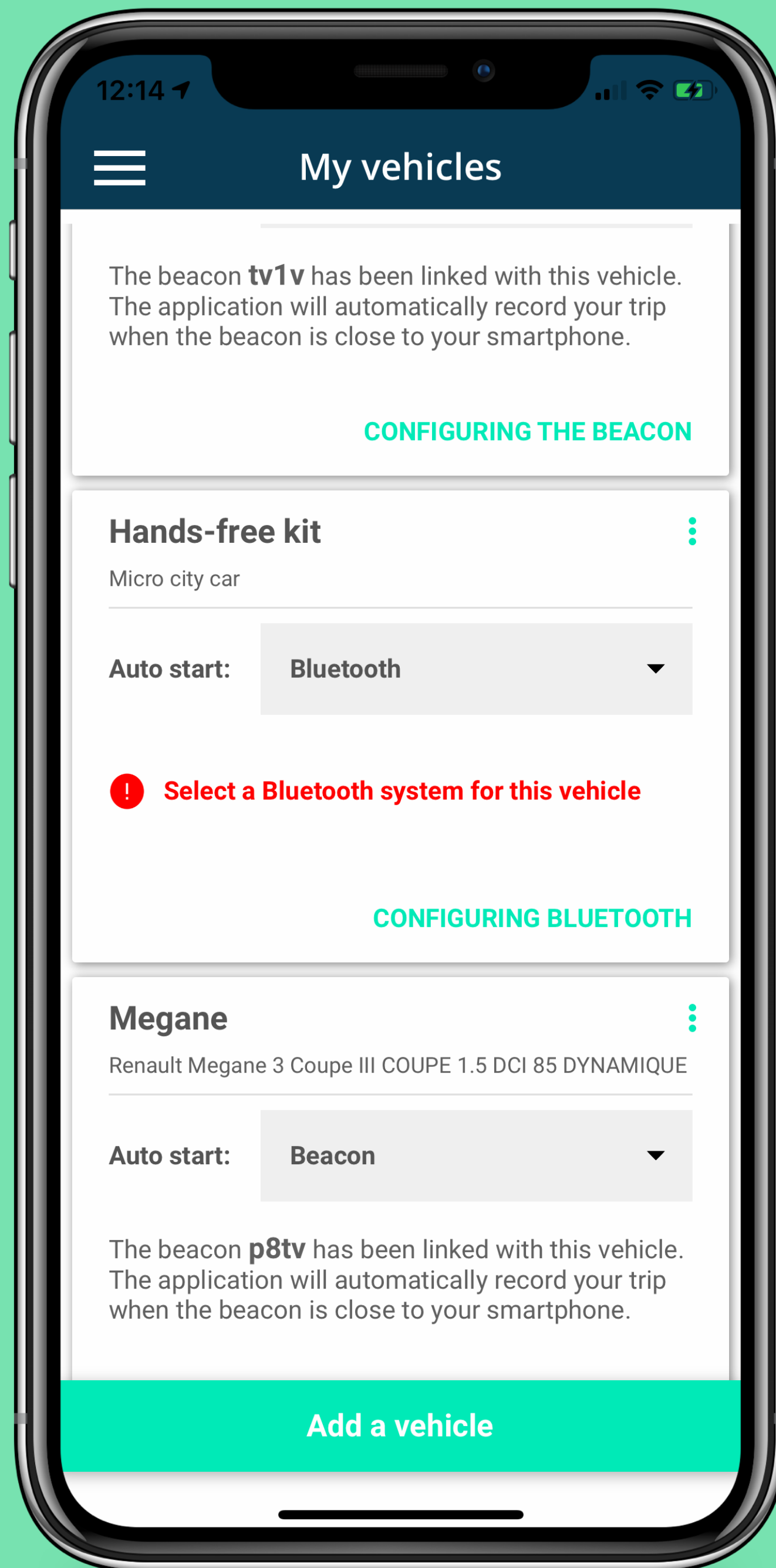

Once the trigger mode has been chosen, click on **CONFIGURING BLUETOOTH**



STEP n°5

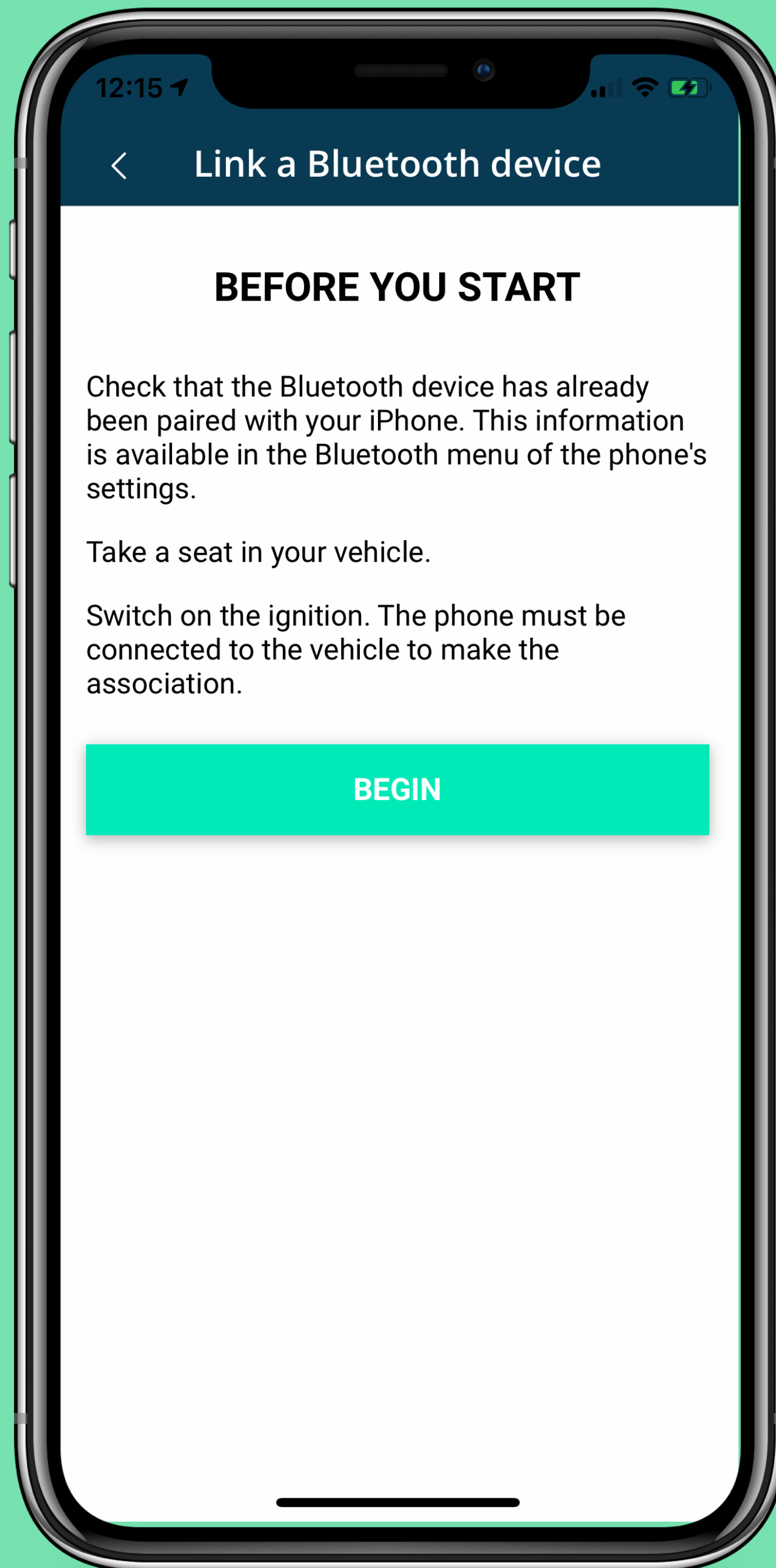

Make sure your phone is currently connected to your Bluetooth device, and then click **BEGIN**



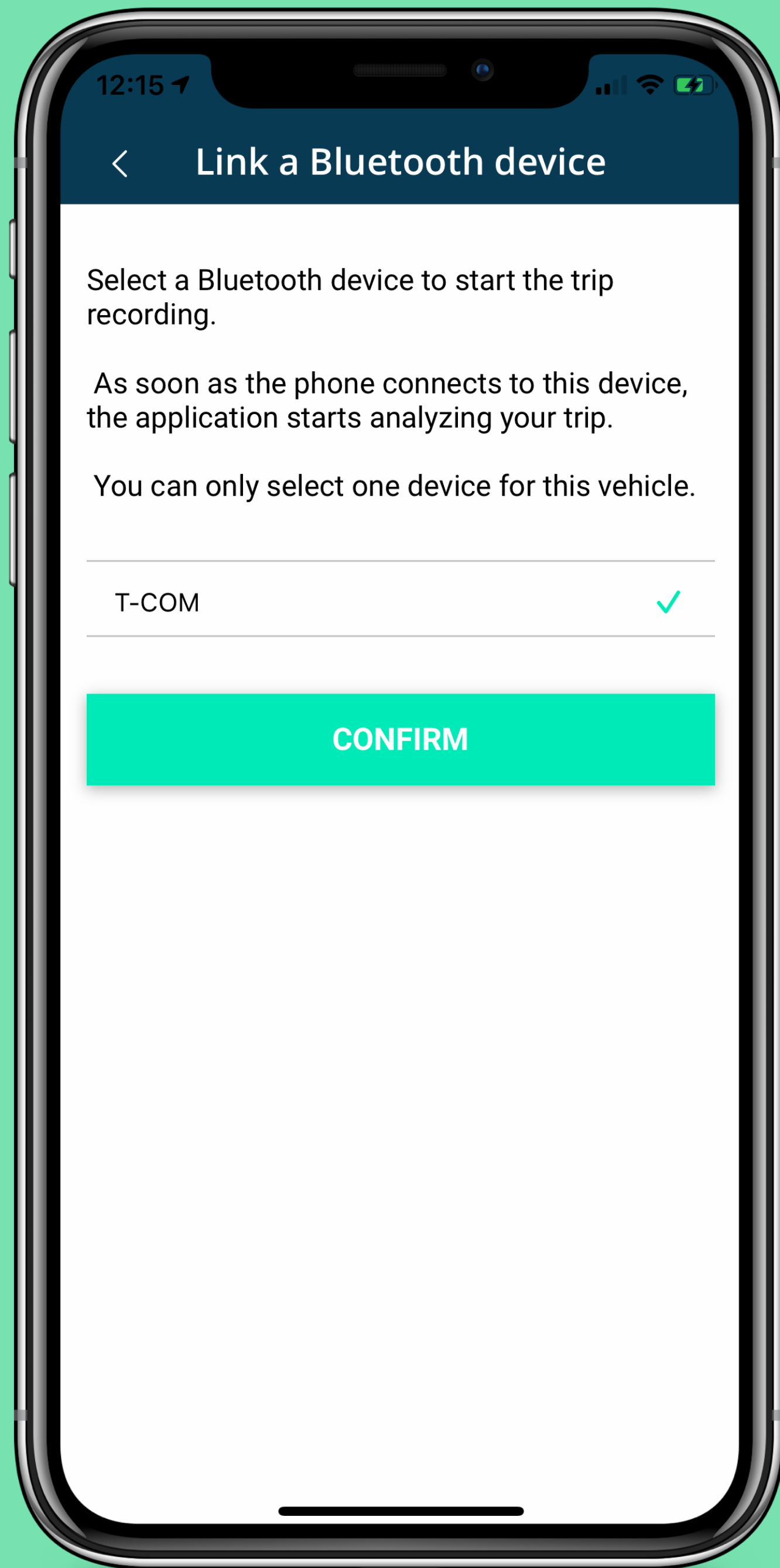

STEP n°6



Select the Bluetooth device corresponding to your vehicle, click on **CONFIRM**



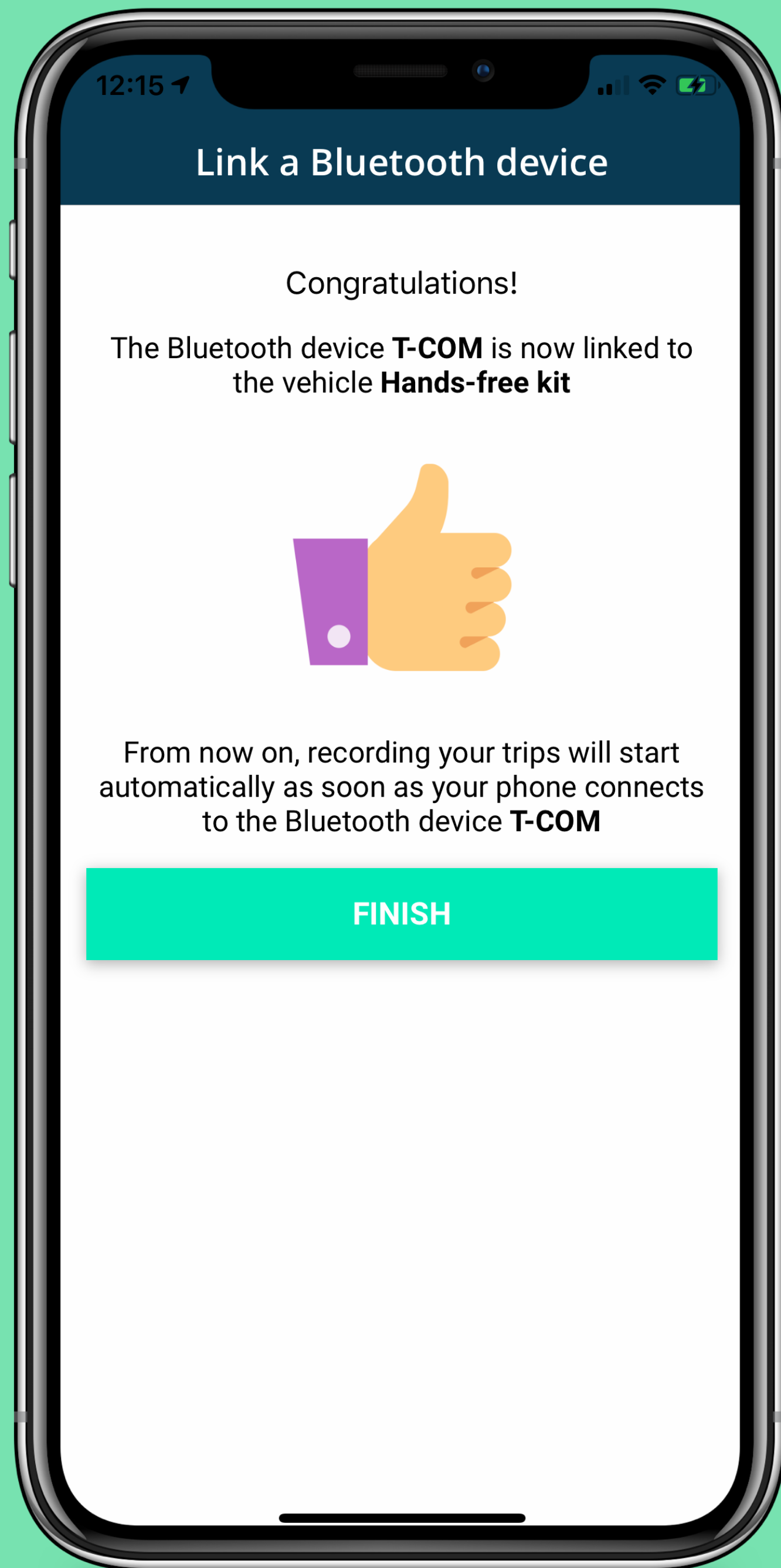

STEP n°7

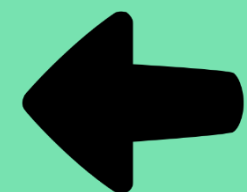

The application is connected to your Bluetooth device.
Click **FINISH**



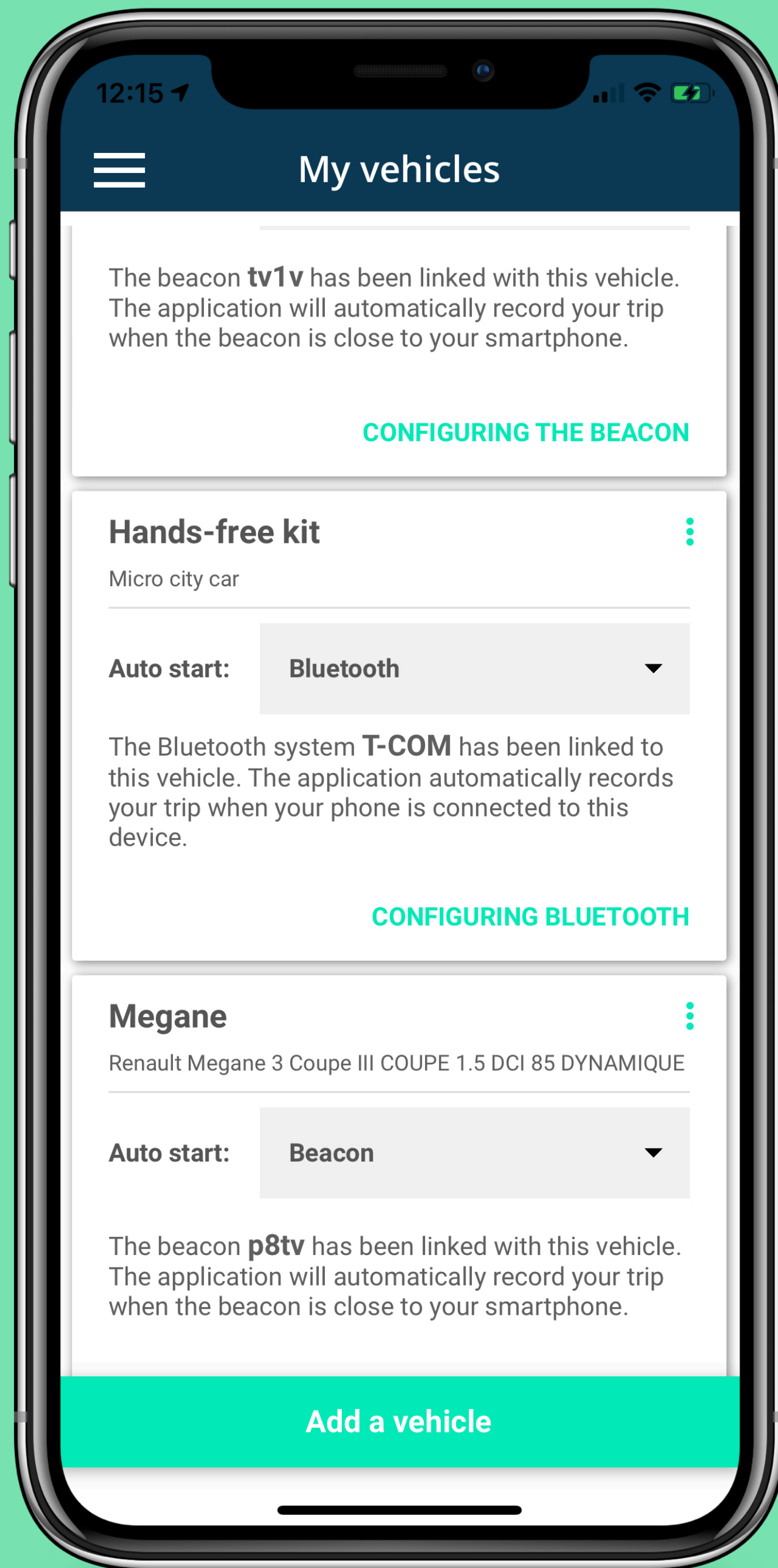

END

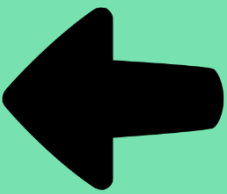

The identifier of the Bluetooth device appears on the card of the vehicle with which it is associated.

